

Part I
Media Twist Setup Instructions

Items

Items: 1x base with stabilizing foot and grommet; 1x bottom upright section; 1x middle upright section; 1x top upright section with media bracket; 1x light; 1x transformer; 1x graphic panel with finishing strips; 2x locking pins; 1x VESA monitor mount; 4x screws; 1x Allen key.

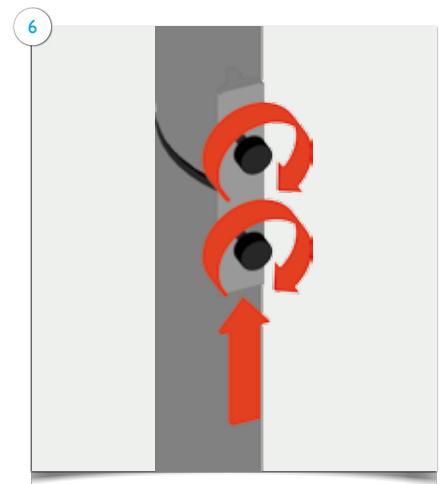
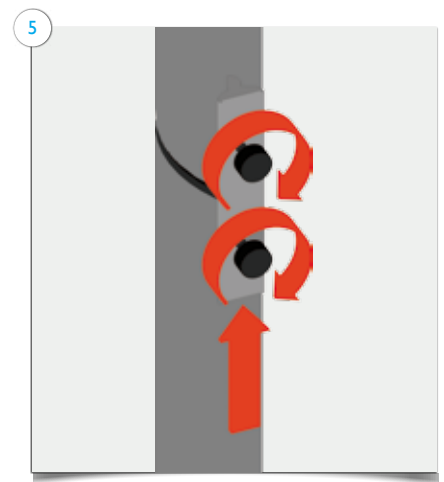
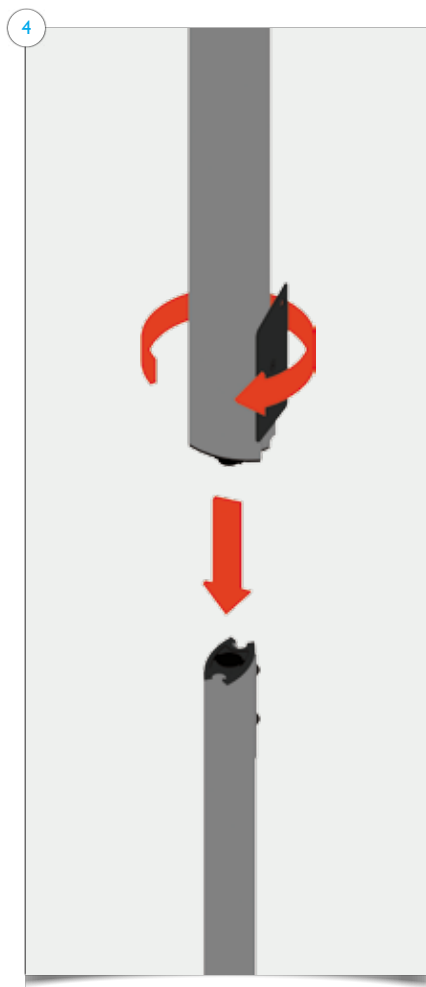
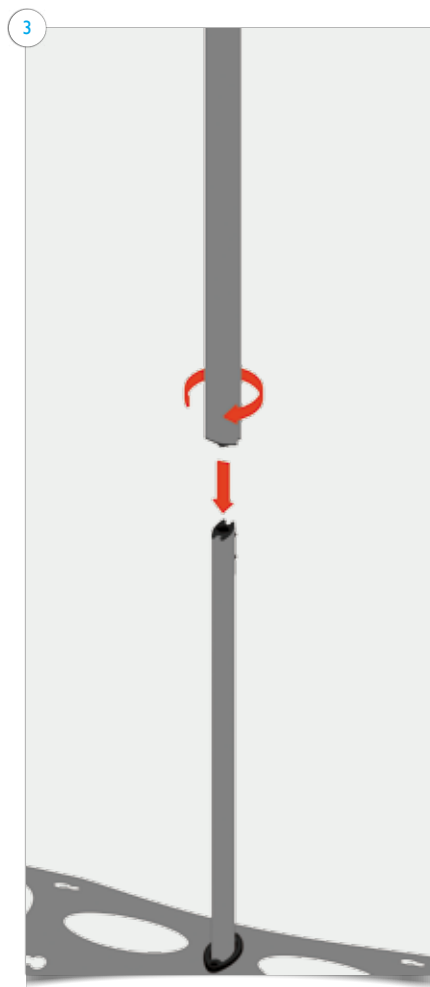
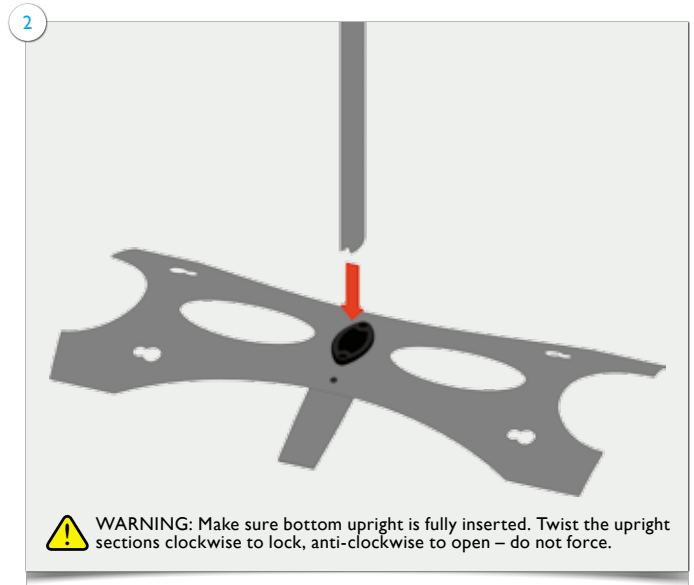
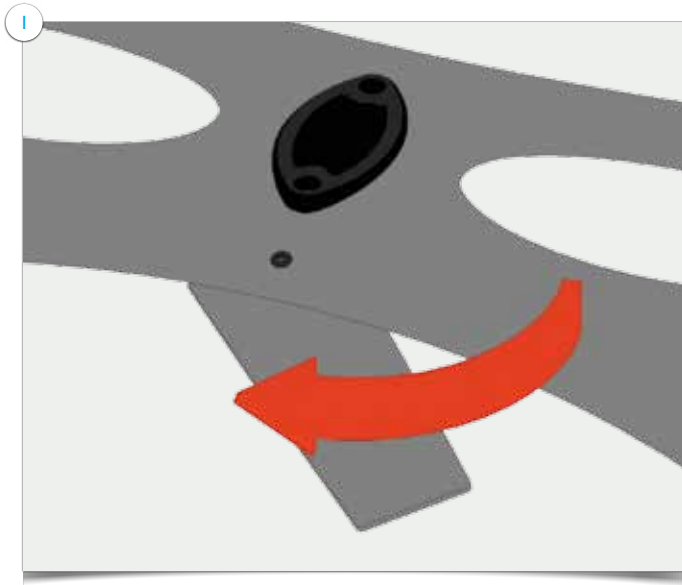

Part2
Media Twist Setup Instructions

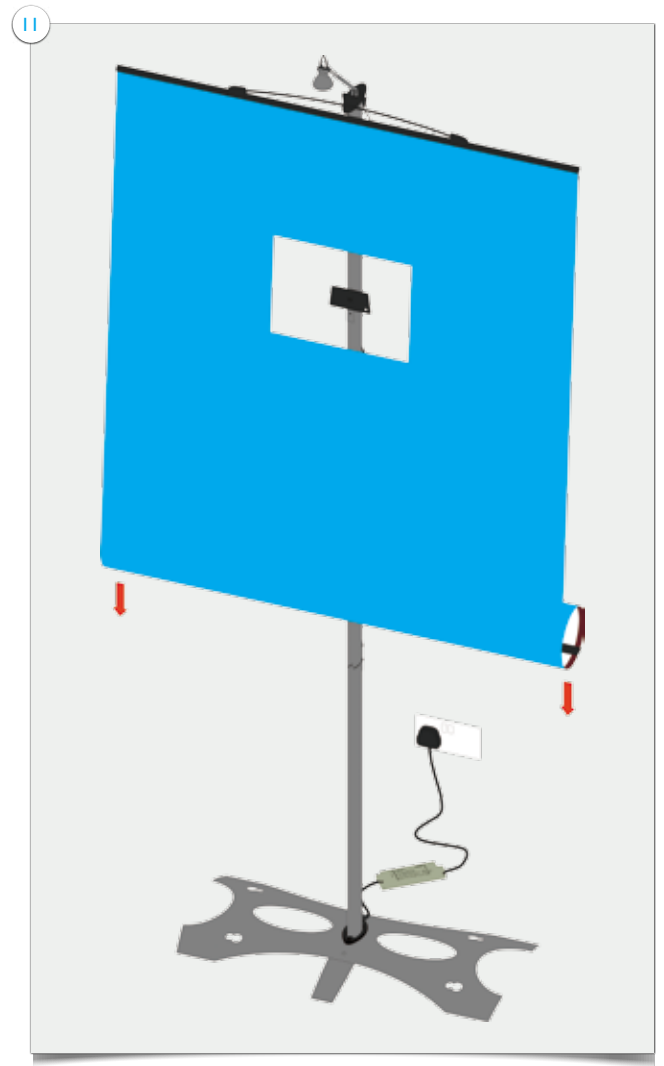
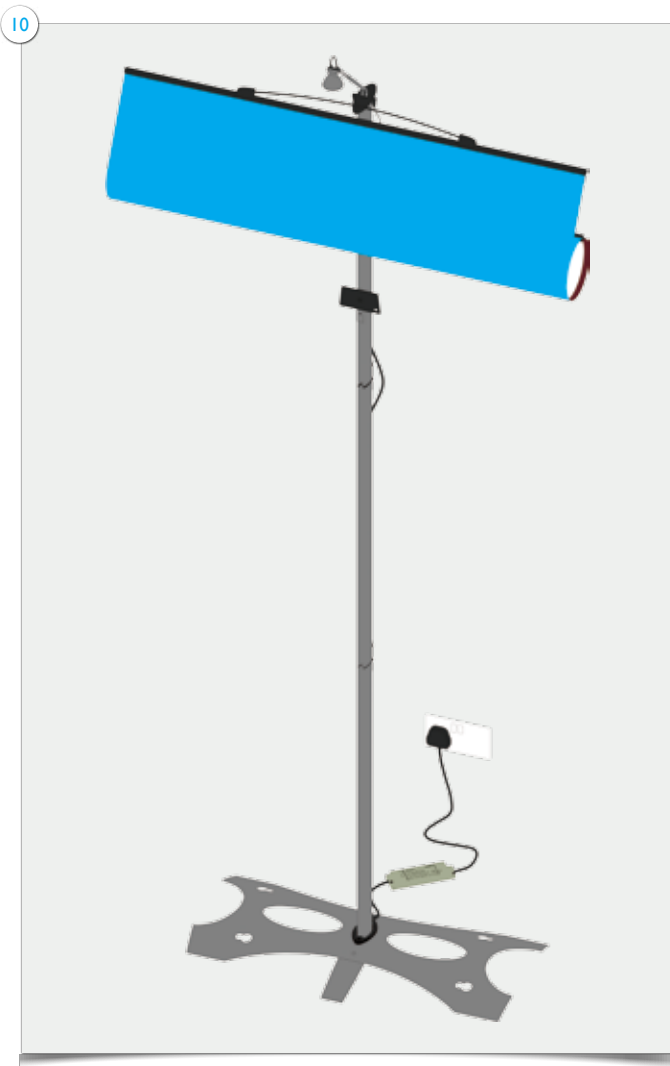
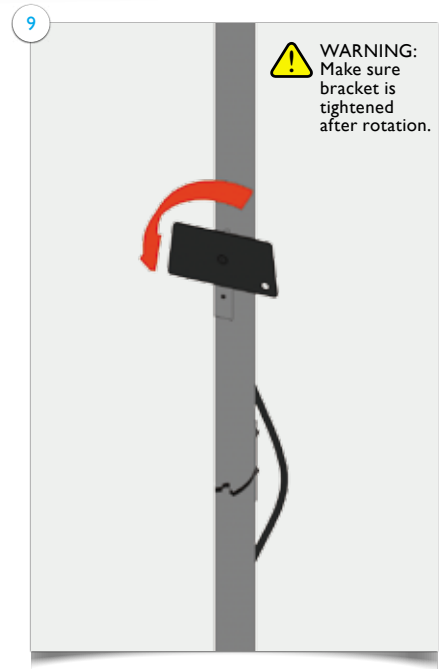
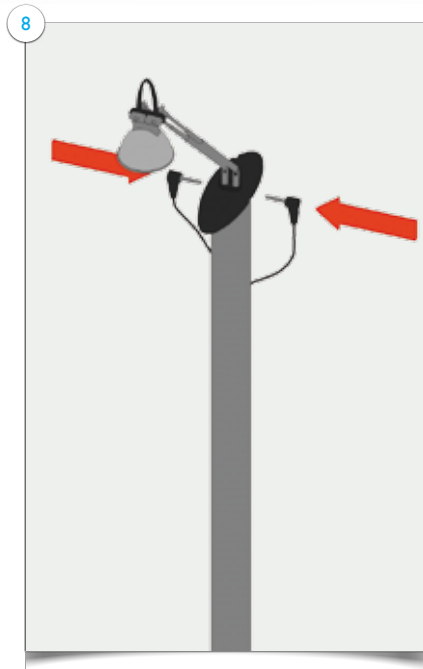
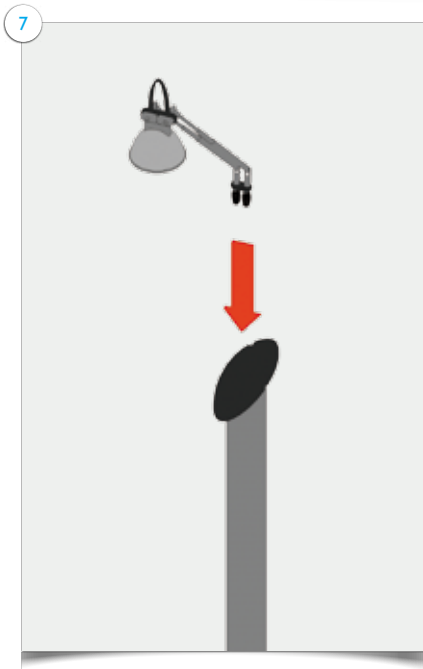

Part3
Media Twist Setup Instructions

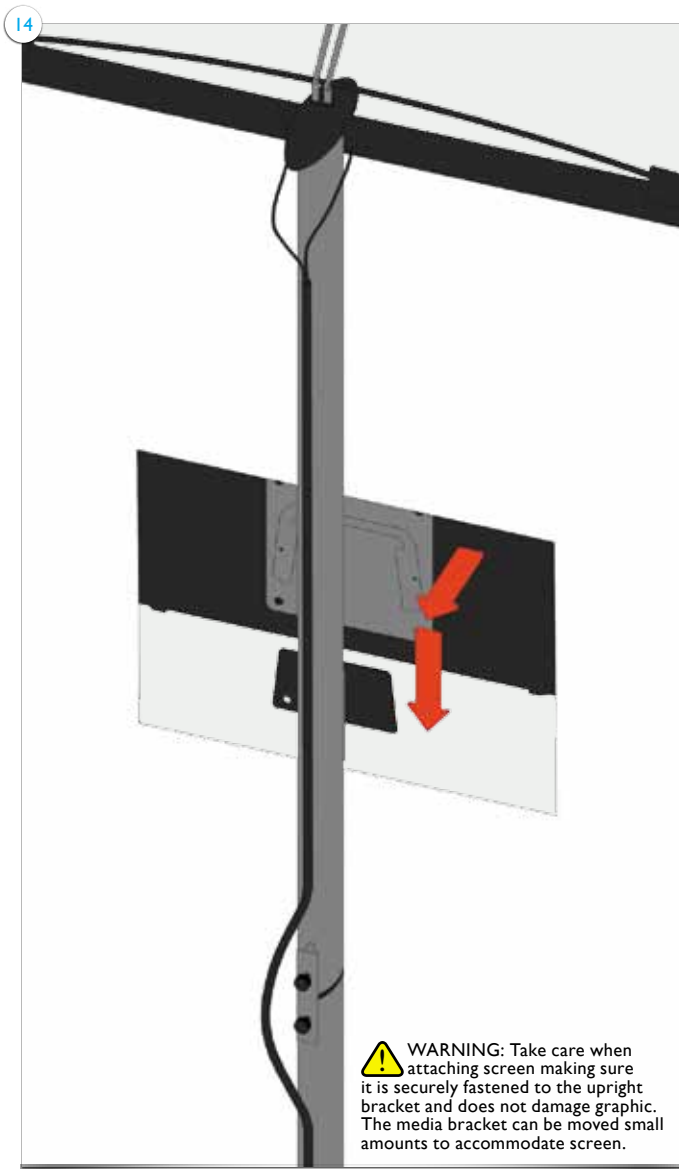
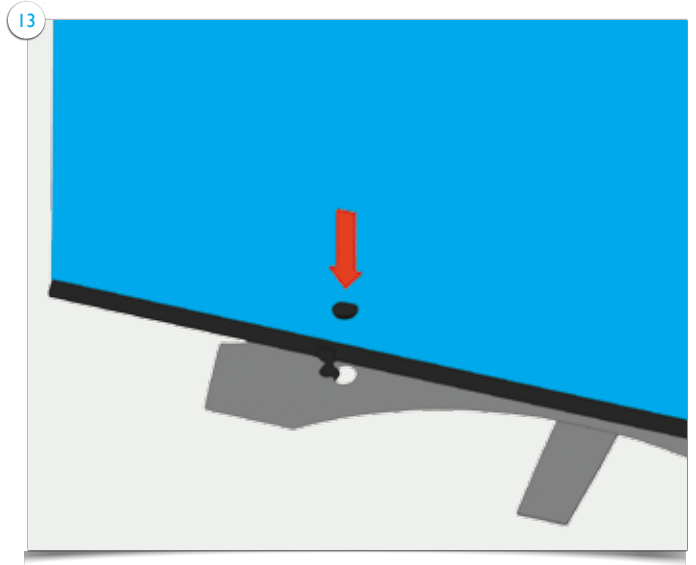
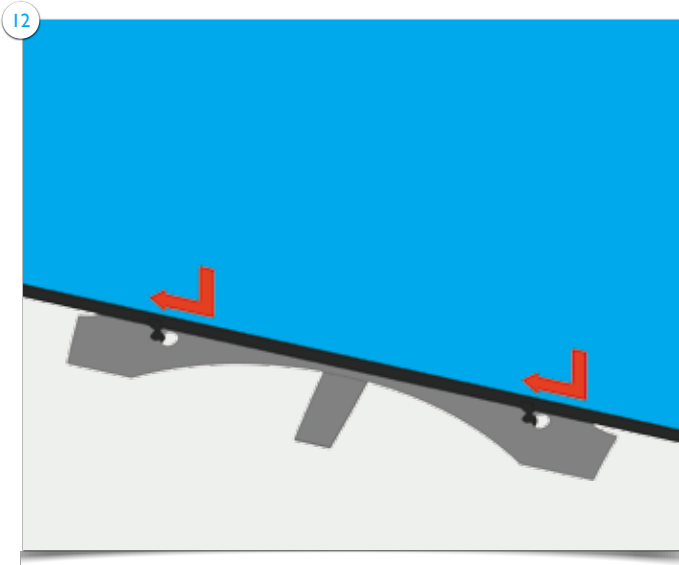

Media Twist Setup Instructions

