

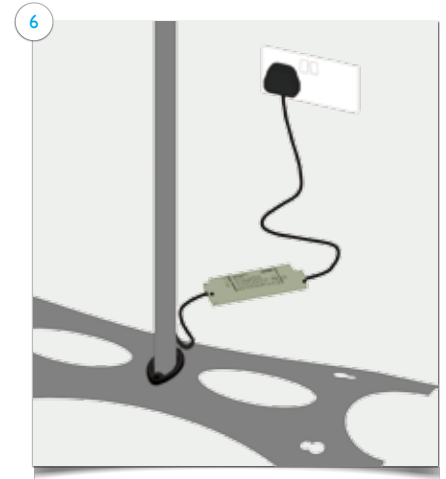

Part I  
Original Twist Setup Instructions

Items

1x base with rubber grommet; 1x bottom upright section; 1x middle upright section; 1x top upright section; 1x light; 1x transformer; 1x graphic panel with finishing strips.

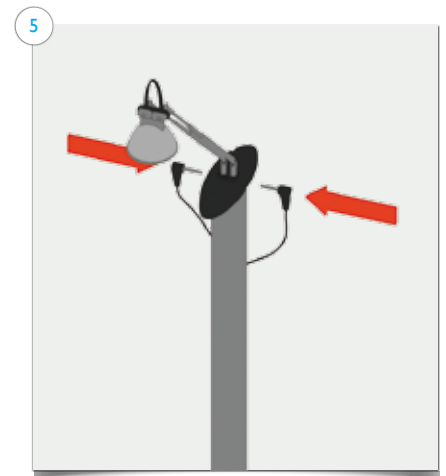
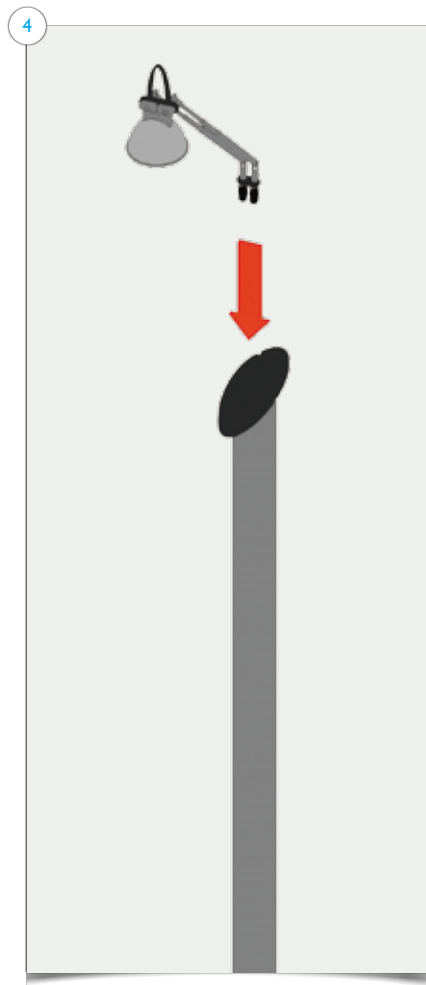
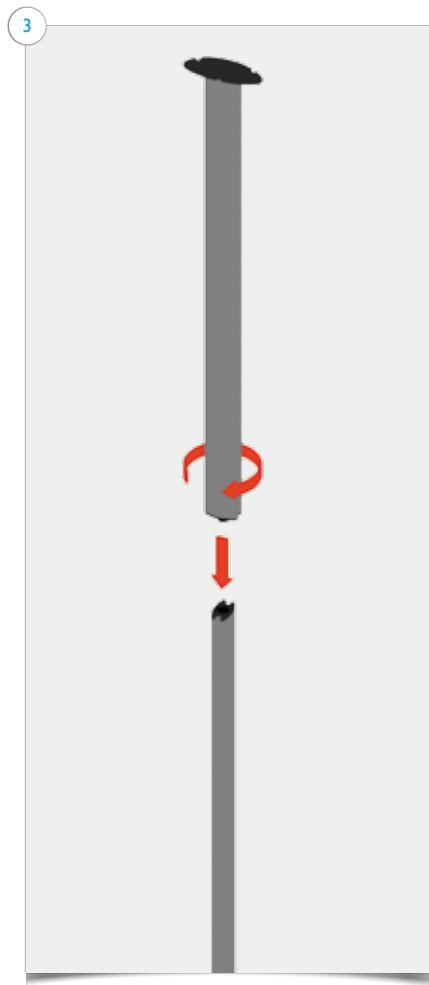
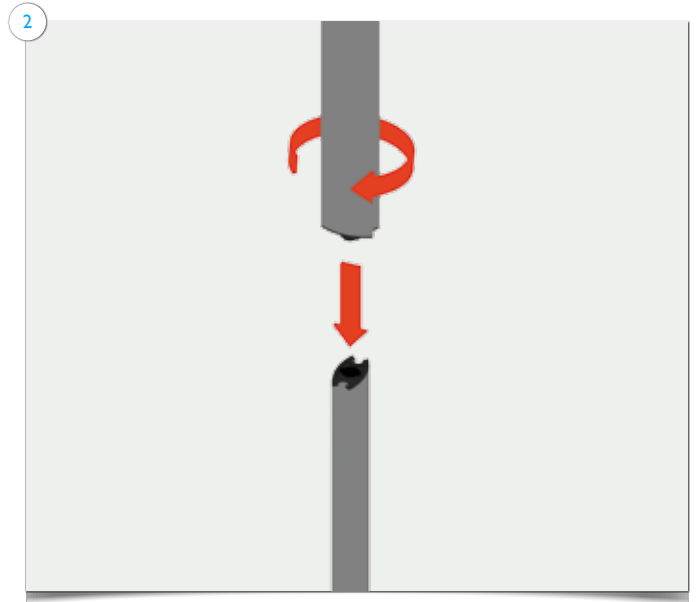
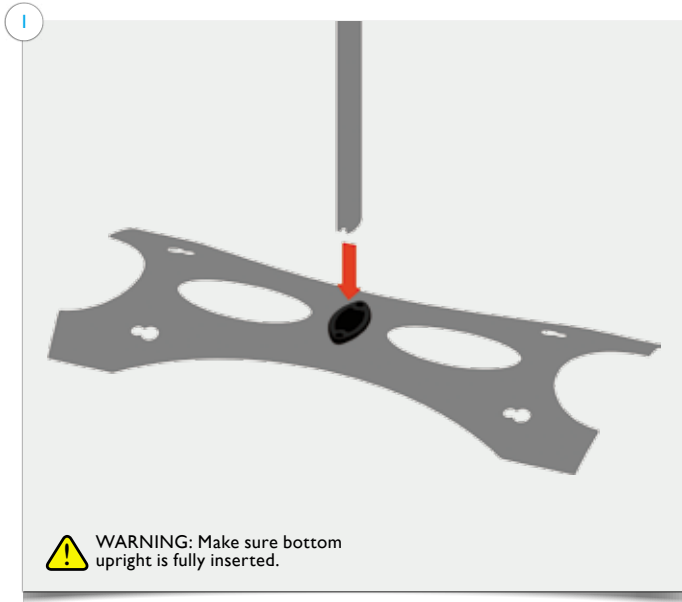

Part2  
Original Twist Setup Instructions

 **WARNING:** Make sure bottom upright is fully inserted. Twist the upright sections clockwise to lock, anti-clockwise to open – do not force.

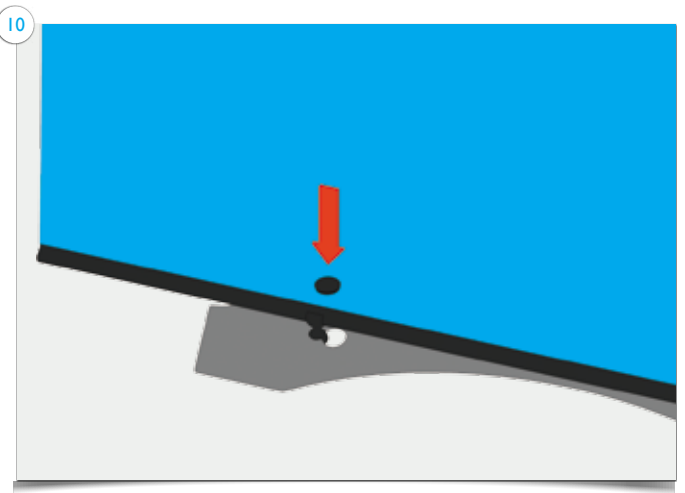
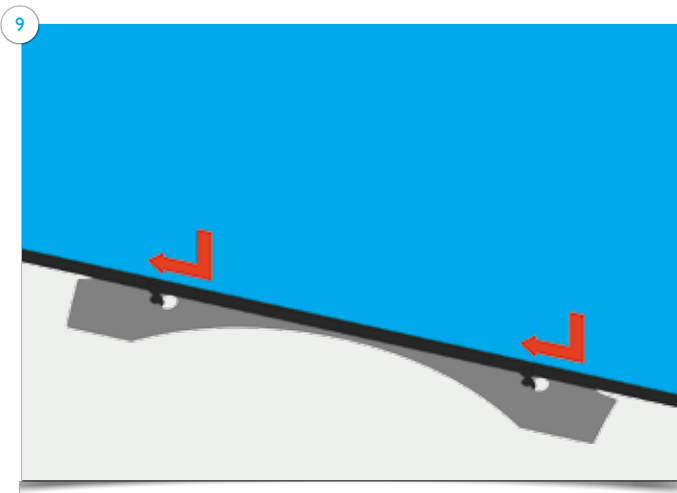
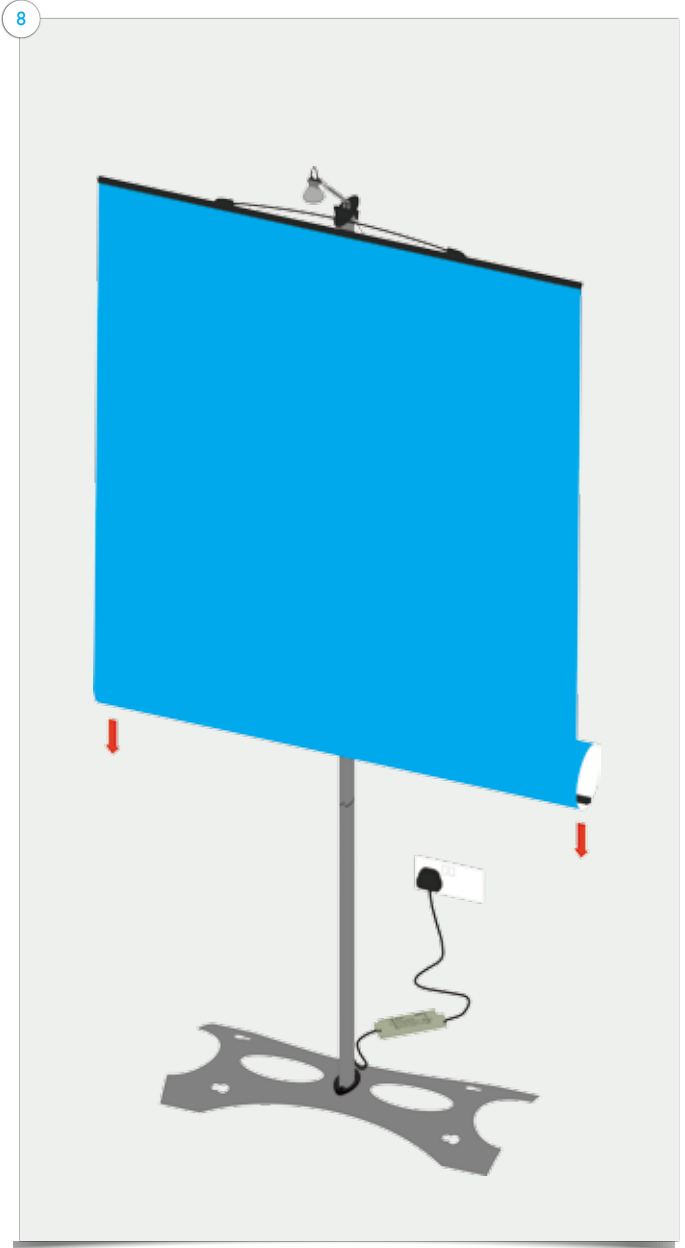
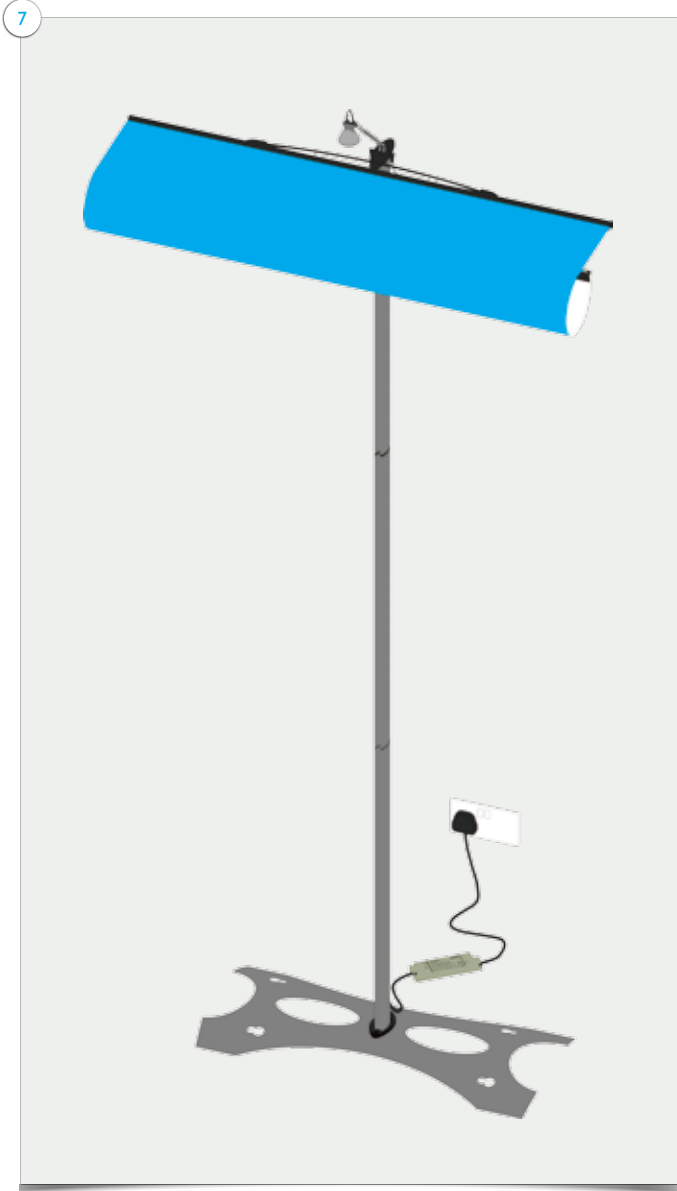

## Original Twist Setup Instructions

